

LONG TERM CLOSURES AT CARVER AVE.

Monday, December 21st through December 2017 (estimated)

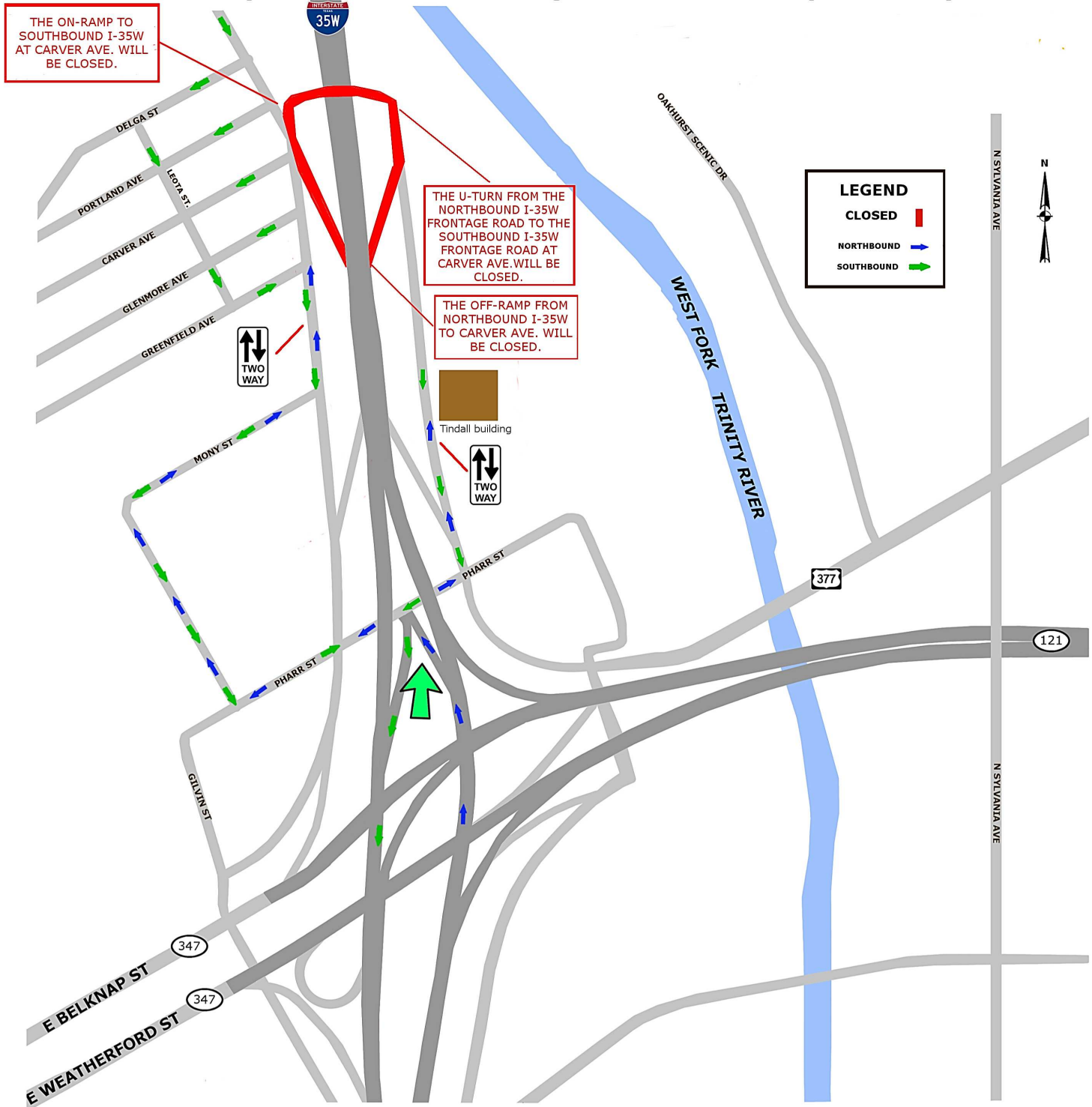

The off-ramp from northbound I-35W to Carver Ave. will be closed. Traffic will be redirected to the previous exit at Pharr St.

The on-ramp to southbound I-35W at Carver Ave. will also be closed. Traffic will be redirected to the next entrance at Pharr St.

The U-turn from the northbound I-35W frontage road to the southbound I-35W frontage road at Carver Ave. will also be closed.

Please note: A temporary northbound and southbound I-35W frontage road will be located between Mony St. and Greenfield Ave. to access the Greenway neighborhood.