



**CONSTRUCTION ALERT**  
**March 10, 2017**

**CONTACT:** Tommy Williamson  
(817) 914-0543  
[twilliamson@ferrovial.us](mailto:twilliamson@ferrovial.us)

**MAJOR CLOSURES ALONG I-35W BETWEEN I-30 AND I-820 SCHEDULED THIS WEEKEND**

**FORT WORTH, Texas** – On **Friday, March 10** and **Sunday, March 12** from **9 p.m. until 5 a.m. Monday** there will be several closures along the I-35W corridor between I-30 and I-820. A complete list of closures and traffic redirections is as follows:

Friday, March 10, 9 p.m. to 10 a.m.

- The direct connector from eastbound I-30 to northbound I-35W will be closed. Traffic will be redirected to Rosedale St.
- The direct connectors from southbound I-35W to eastbound and westbound I-820 will be closed. Traffic will be redirected to Meacham Blvd.
- The direct connector from eastbound I-820 to northbound I-35W will be closed. Traffic will be redirected to Haltom Rd.
- Rolling closures on the direct connector from eastbound and westbound Spur 280 to northbound I-35W.

Sunday, March 12, 9 p.m. to 5 a.m.

- All lanes of northbound I-35W at 28<sup>th</sup> St. will be closed. Traffic will be redirected along the frontage road.
- All lanes of eastbound and westbound 28<sup>th</sup> St. at I-35W will be closed. Eastbound traffic will be redirected to Northside Dr. and westbound traffic will be redirected to 33<sup>rd</sup> St.
- The direct connector from northbound I-35W to SH 121 will be closed. Traffic will be redirected to Northside Dr.

This work is weather-permitting. **Updated closure information is posted daily** on Twitter ([@NTEExpress](https://twitter.com/NTEExpress)) and Facebook ([facebook.com/northtarrantexpress](https://facebook.com/northtarrantexpress)) and [northtarrantexpress.com](http://northtarrantexpress.com).

This work is part of the \$1.4 billion North Tarrant Express 35W project, which includes a 6.5-mile section that is currently ranked 23<sup>rd</sup> on the state's most congested roadway list. Ranked sixth when construction began in 2013, this section of I-35W from north of I-30 to north of I-820 including the I-35W/I-820 interchange in Fort Worth is already seeing traffic improvements with the reconstruction of main lanes and the addition of TEXpress managed lanes.

Drivers are encouraged to “Know Before They Go,” and visit [www.northtarrantexpress.com](http://www.northtarrantexpress.com) for upcoming closures. To view detour maps, please visit the [Alternate Route Map](#) page of our website. Also, as our lane closures are updated frequently, please visit the [Lane Closures](#) page on our website daily for the most current information. Closures are subject to weather conditions, and construction activities may be postponed if necessary.

###



### EASTBOUND I-30 TO NORTHBOUND I-35W CLOSURE

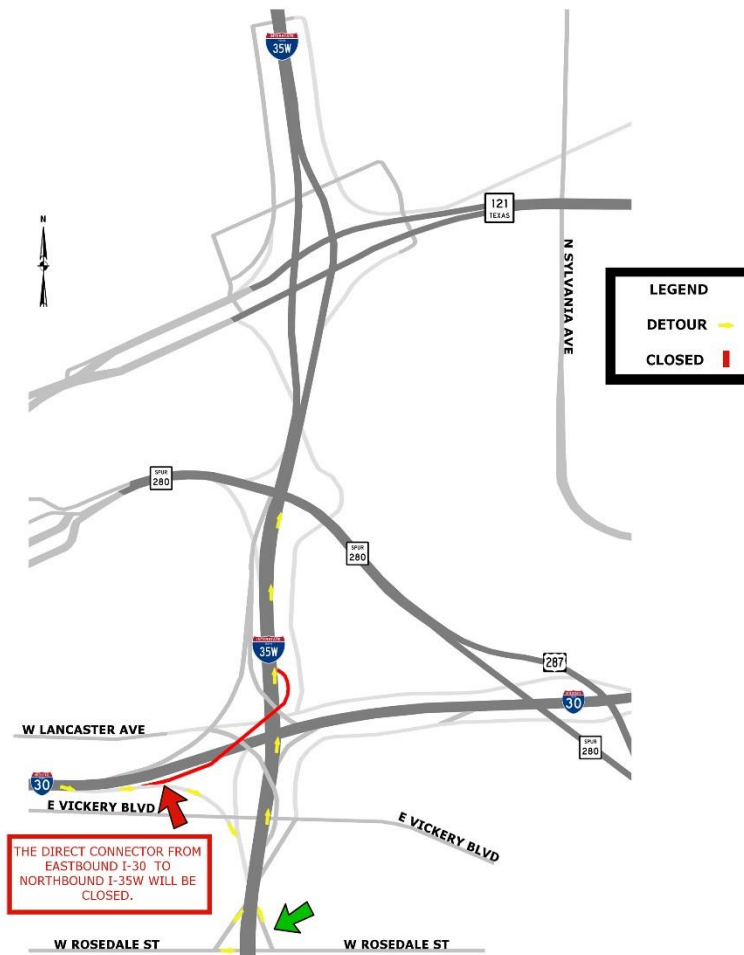

THE DIRECT CONNECTOR FROM EASTBOUND I-30 TO NORTHBOUND I-35W WILL BE CLOSED.

The direct connector from eastbound I-30 to northbound I-35W will be closed.

Traffic will be redirected to Rosedale St.

### CLOSURES AT I-35W & 28TH ST.

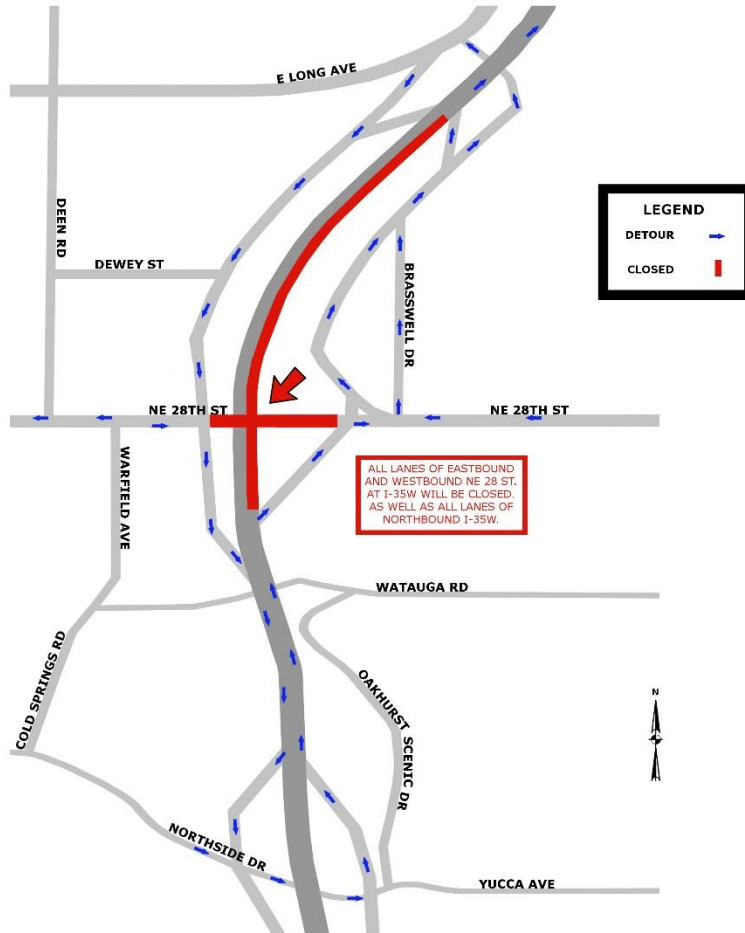

All lanes of northbound I-35W at 28th St. will be closed.

Traffic will be redirected along the frontage roads.

Eastbound traffic will be redirected to Northside Dr. and westbound traffic to 33rd St.